

校舎等建物配置図

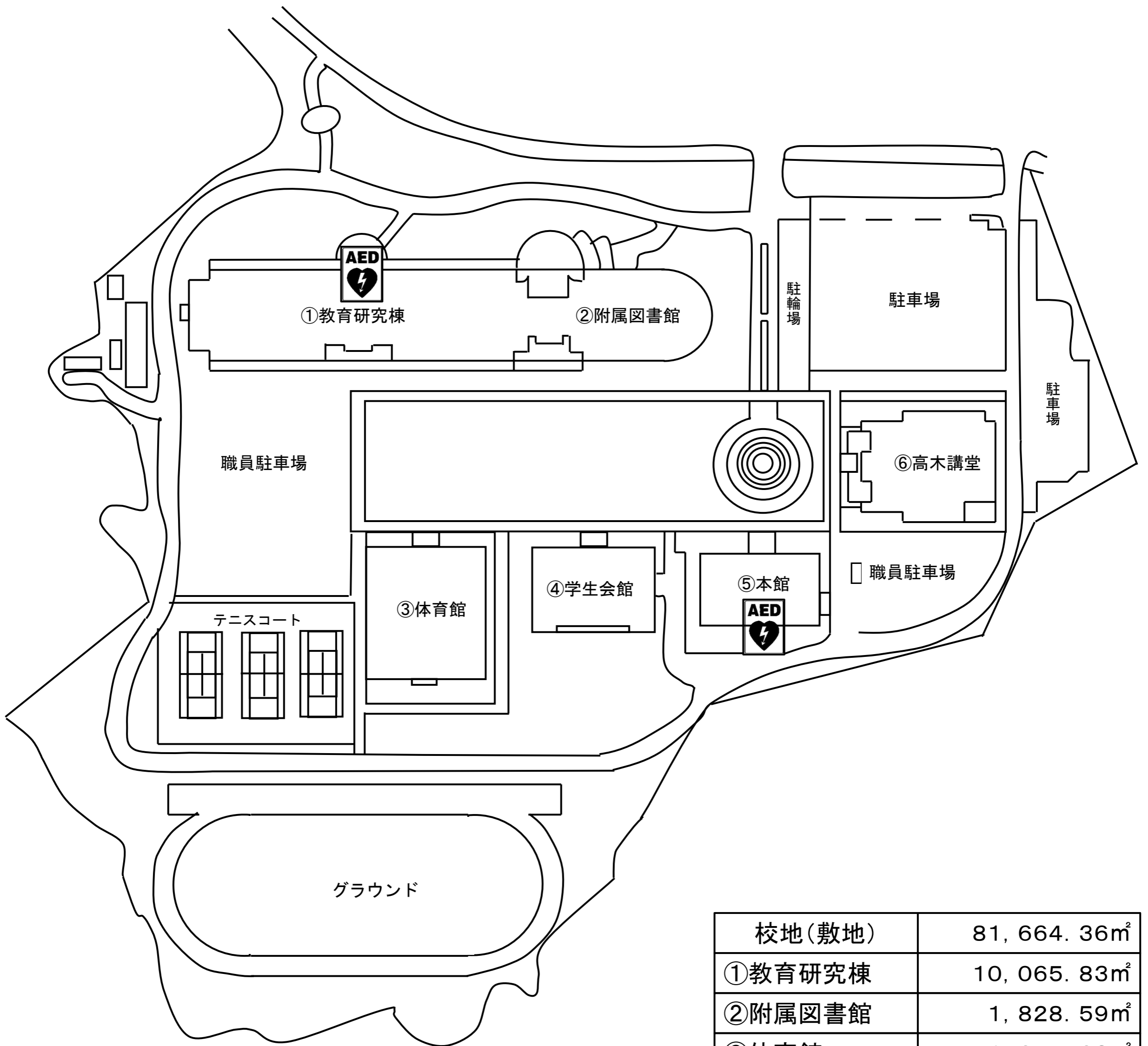

校地(敷地)	81,664.36m ²
①教育研究棟	10,065.83m ²
②附属図書館	1,828.59m ²
③体育館	1,654.63m ²
④学生会館	1,249.28m ²
⑤本館	1,365.64m ²
⑥高木講堂	1,292.07m ²
書庫兼倉庫	48.60m ²
校舎等建物計	17,504.64m ²

校舎等平面図

教育研究棟2階

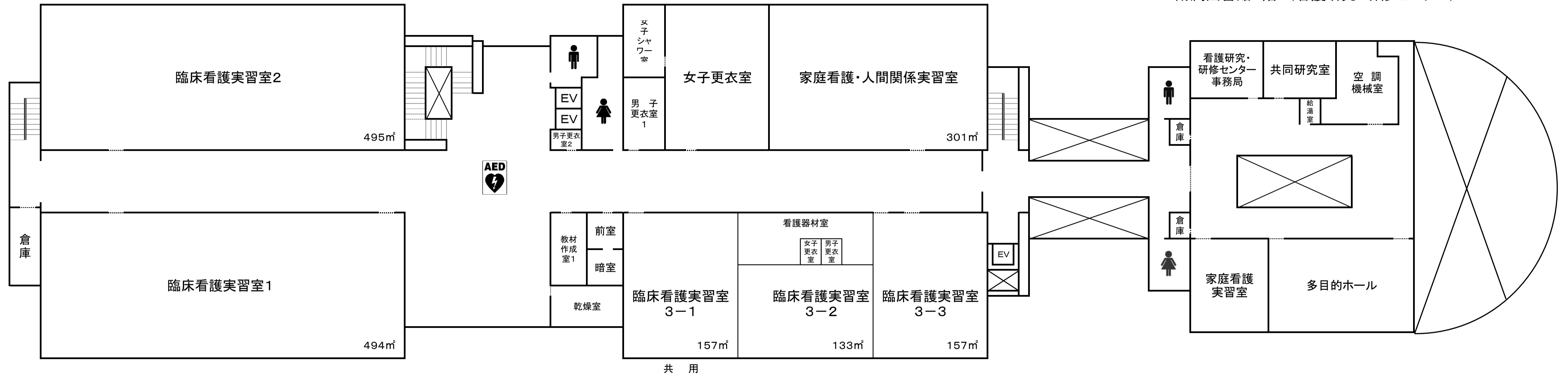

教育研究棟1階

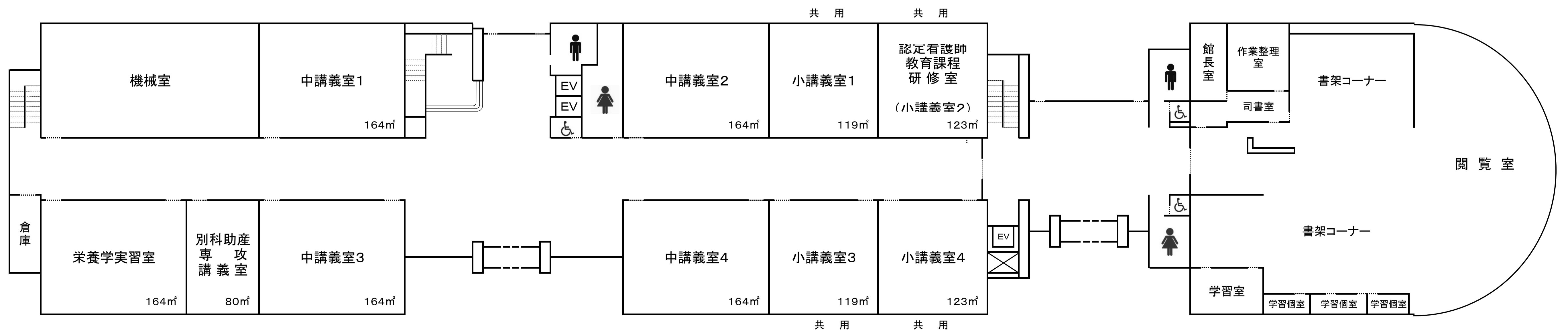

教育研究棟 4階

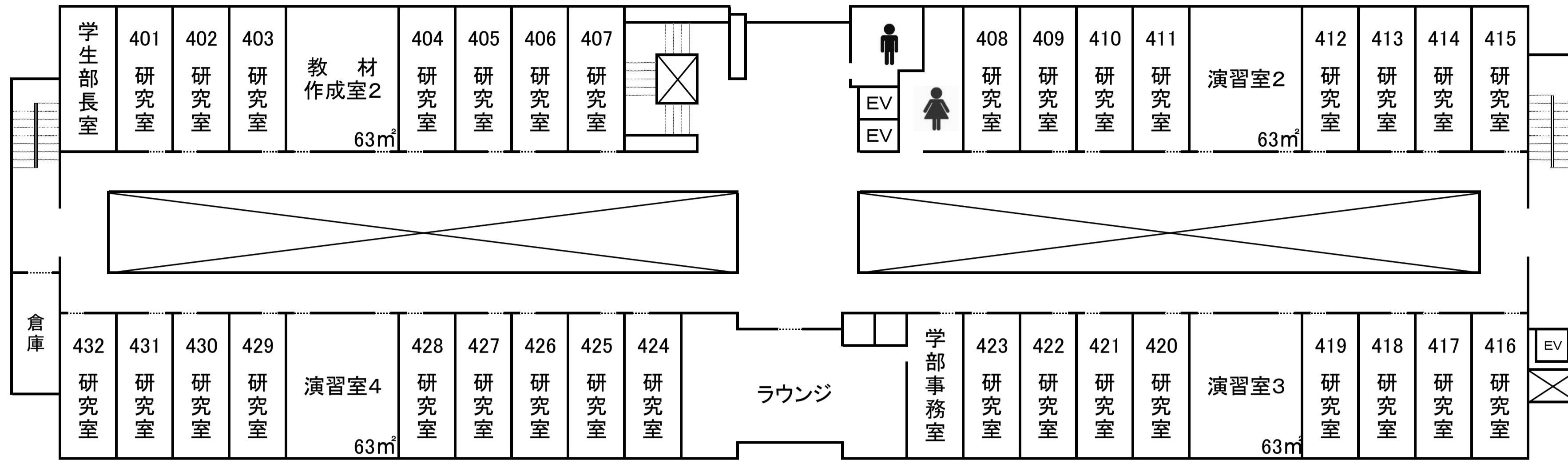

教育研究棟 3階

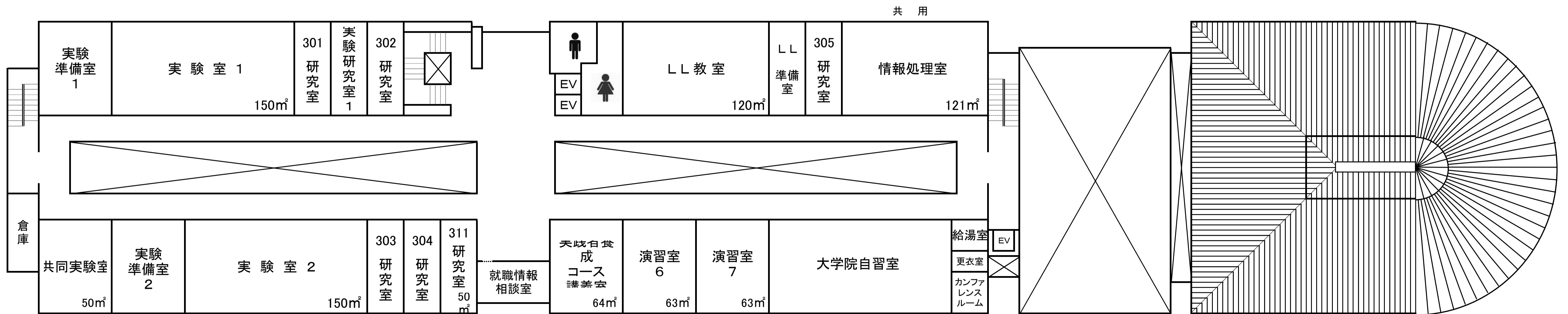

本館2階

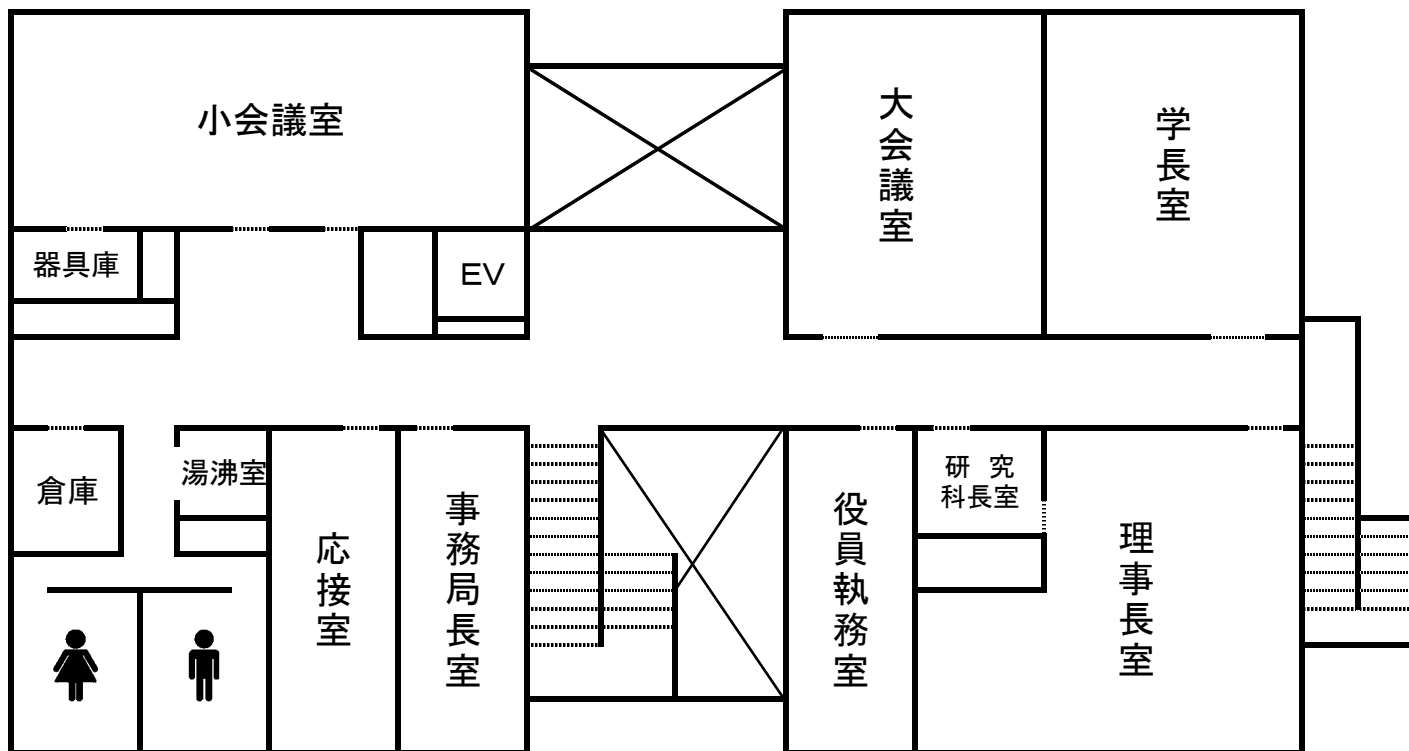

本館1階

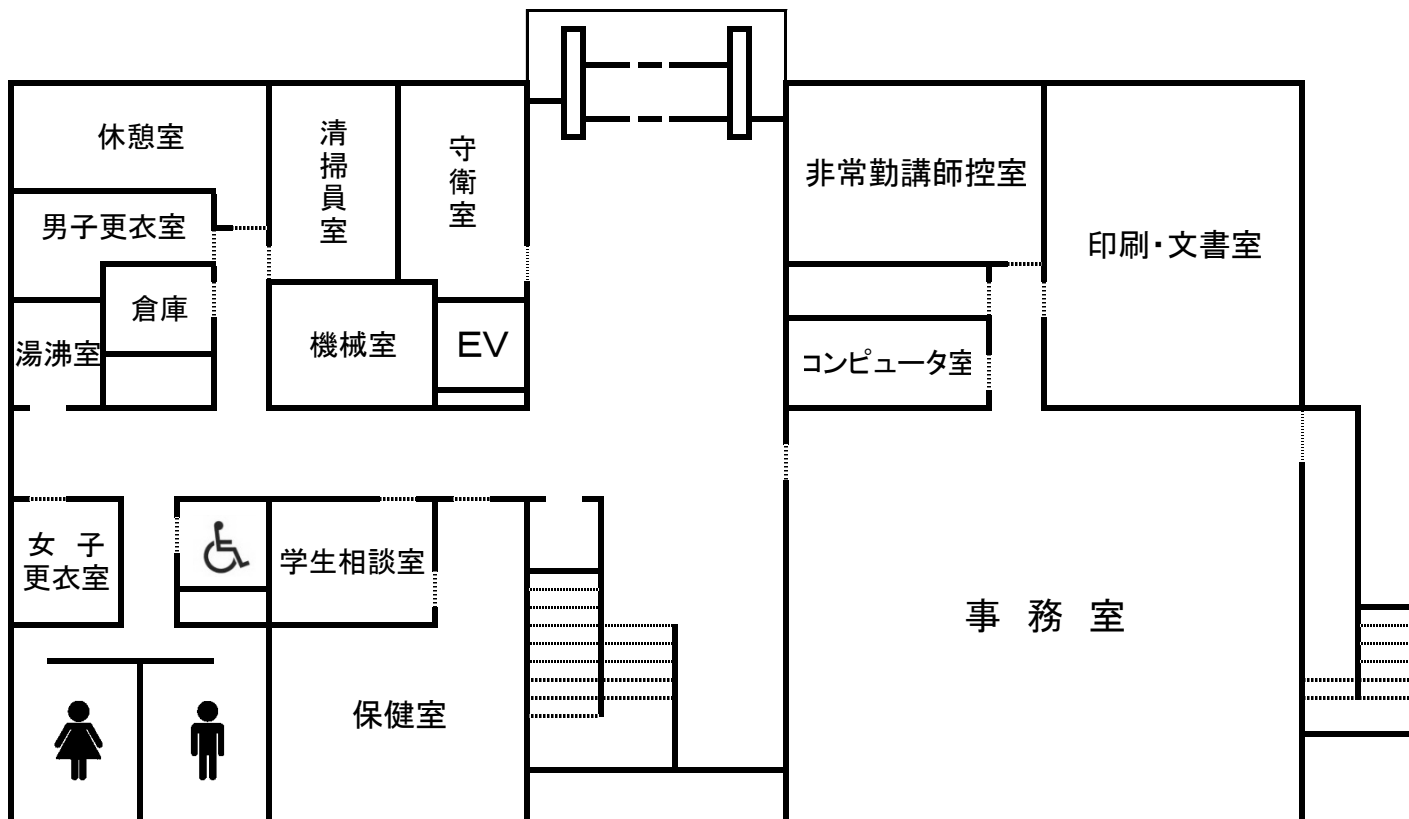

高木講堂 2階

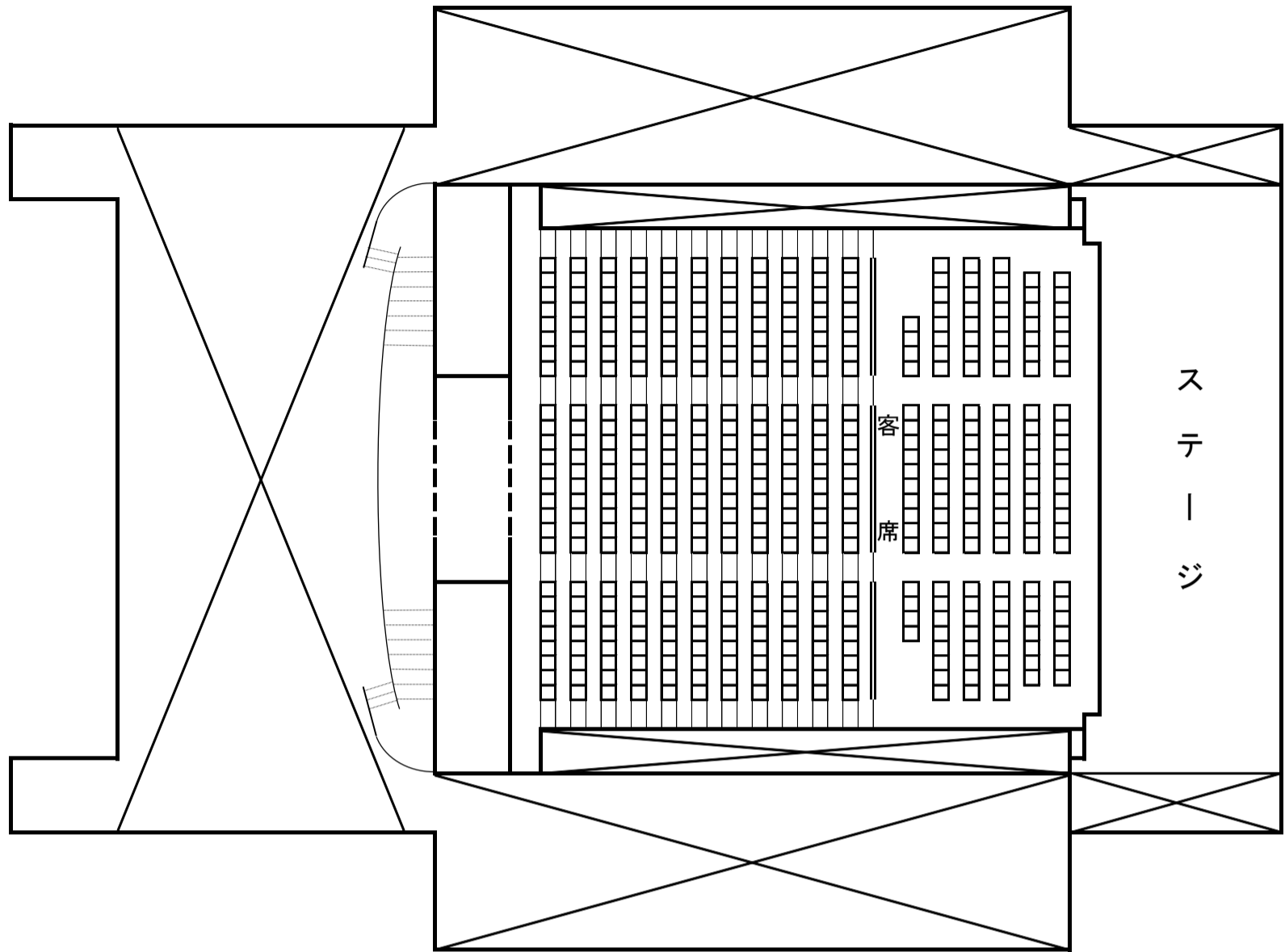

高木講堂 1階

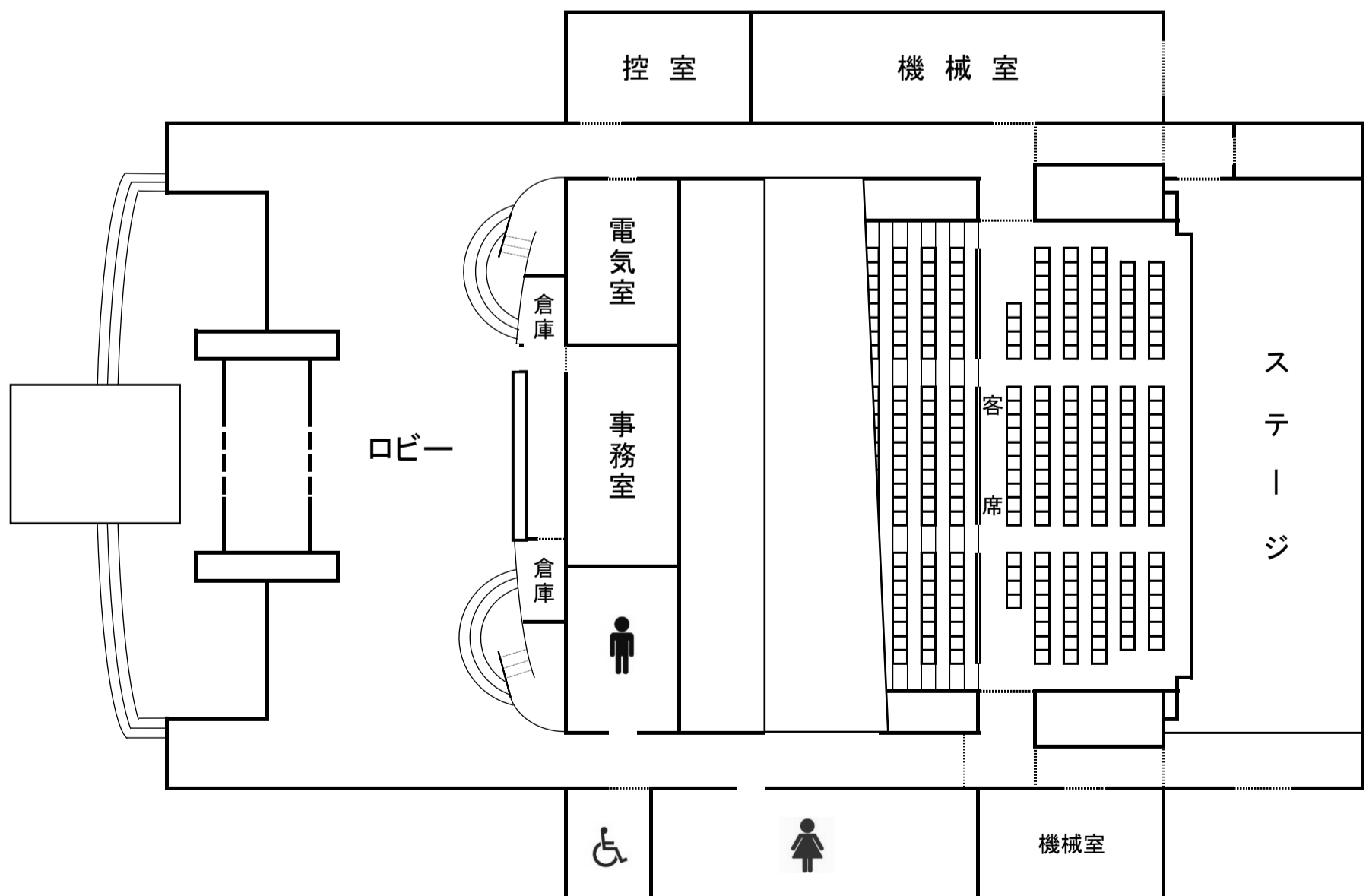

学生会館2階

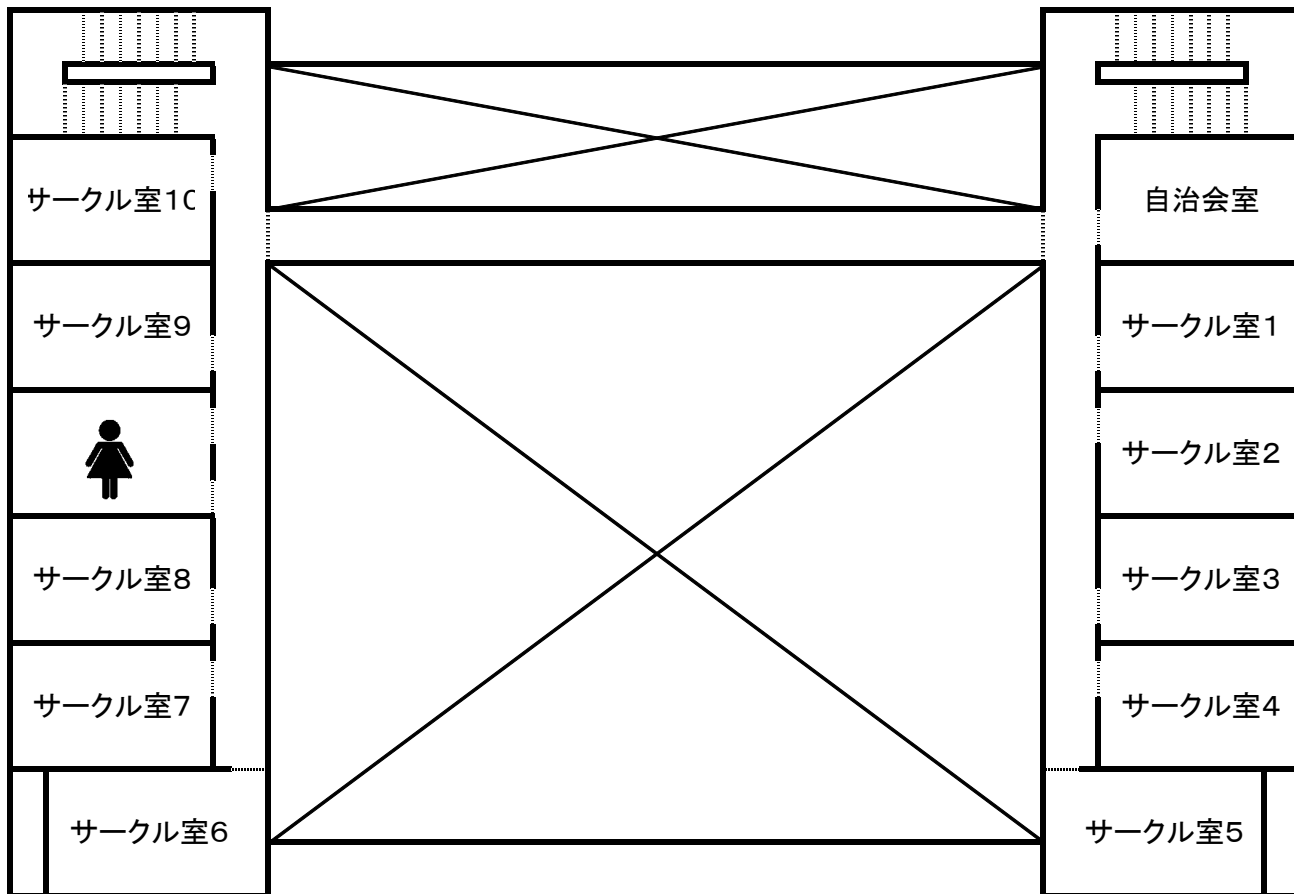

学生会館1階

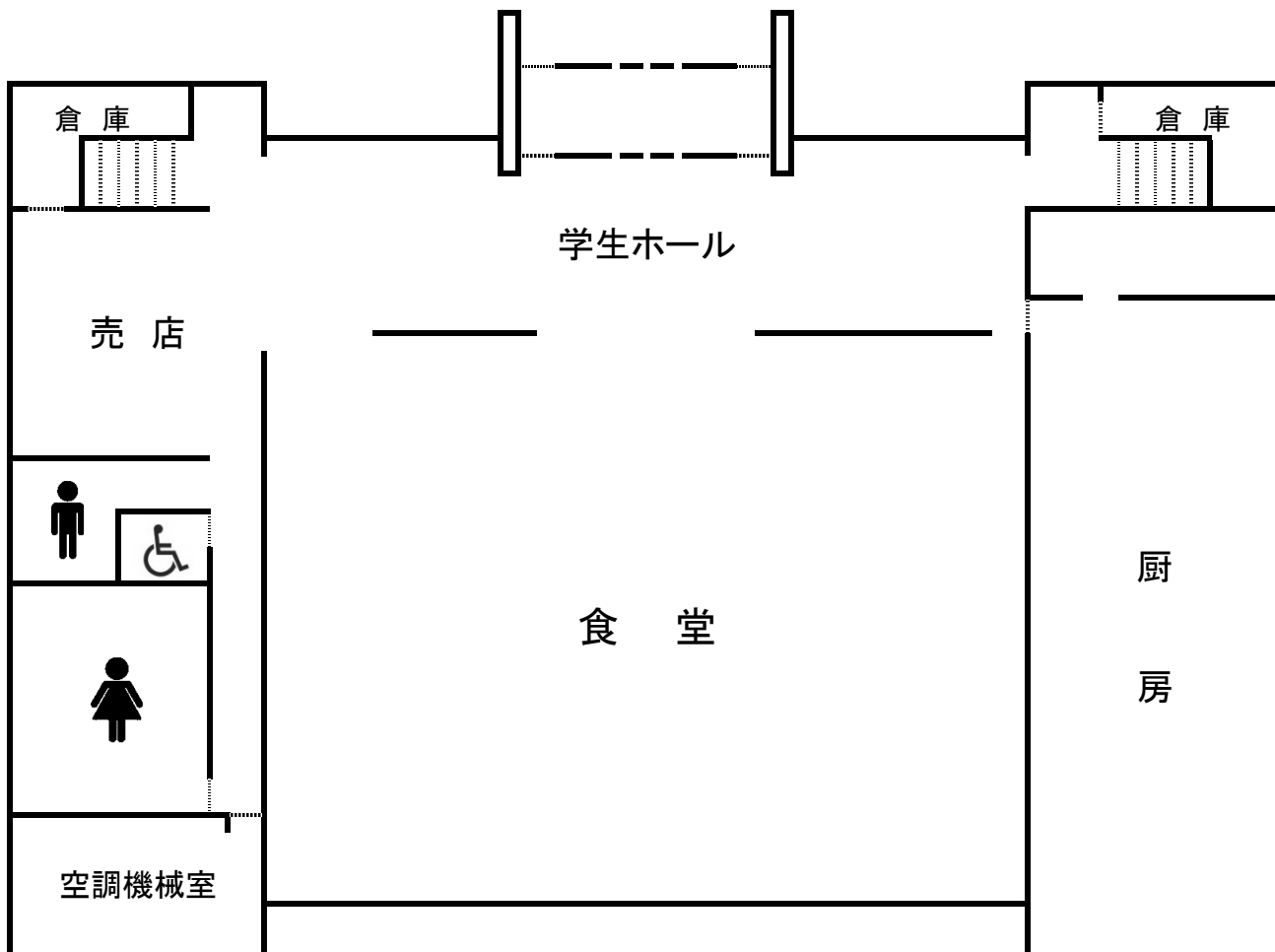

体育館2階

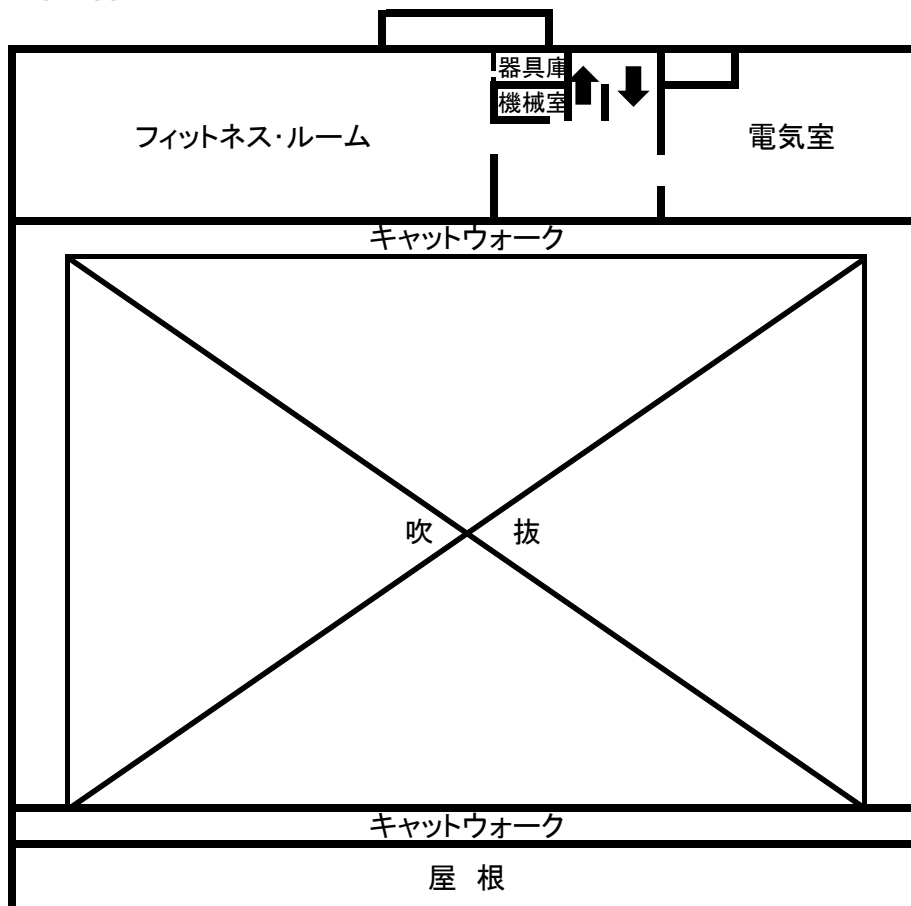

体育館1階

