

# 校舎等建物配置図

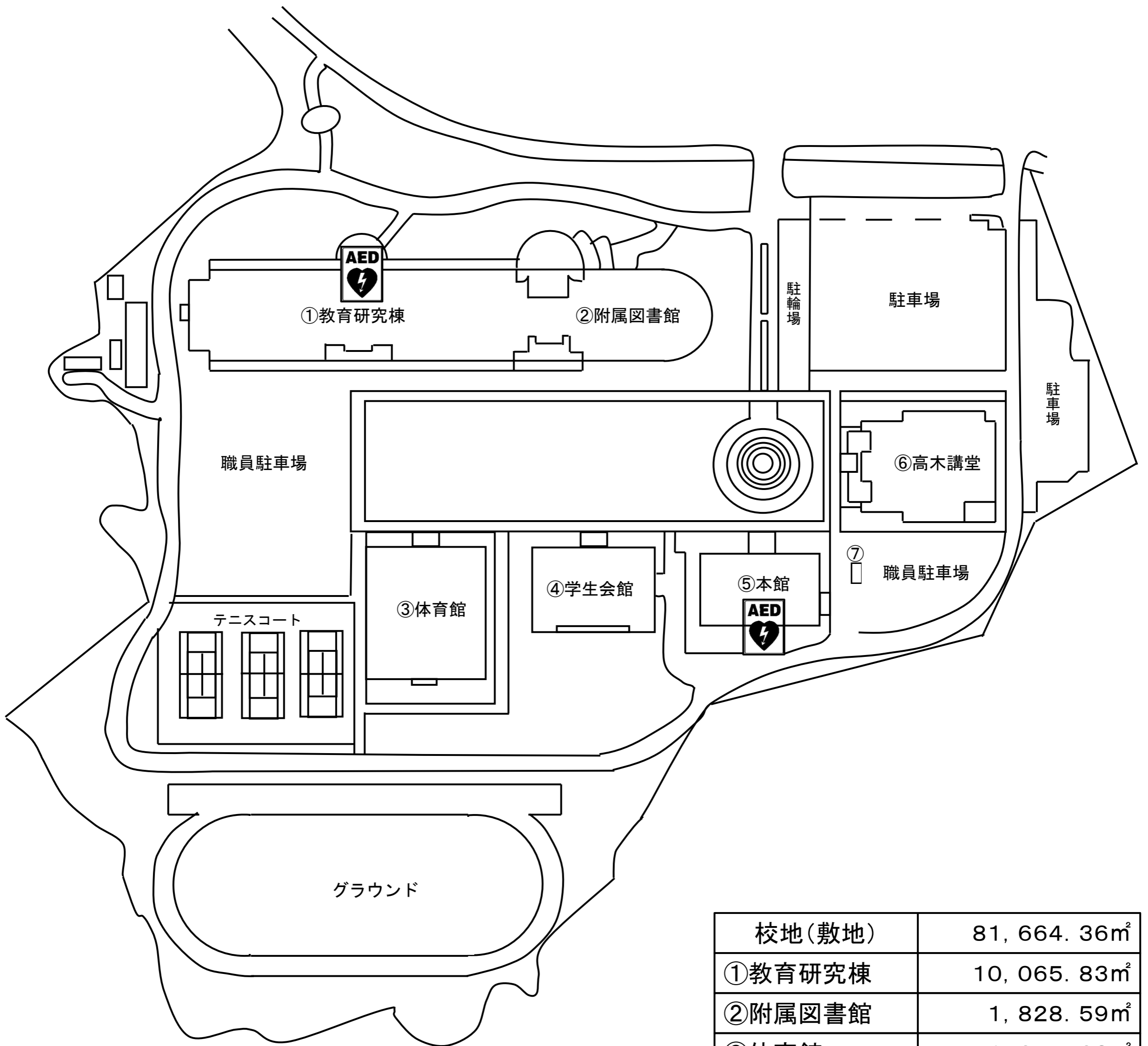

校地(敷地)	81,664.36m <sup>2</sup>
①教育研究棟	10,065.83m <sup>2</sup>
②附属図書館	1,828.59m <sup>2</sup>
③体育館	1,654.63m <sup>2</sup>
④学生会館	1,249.28m <sup>2</sup>
⑤本館	1,365.64m <sup>2</sup>
⑥高木講堂	1,292.07m <sup>2</sup>
⑦車庫	53.01m <sup>2</sup>
校舎等建物計	17,509.05m <sup>2</sup>



教 育 研 究 棟 4 階

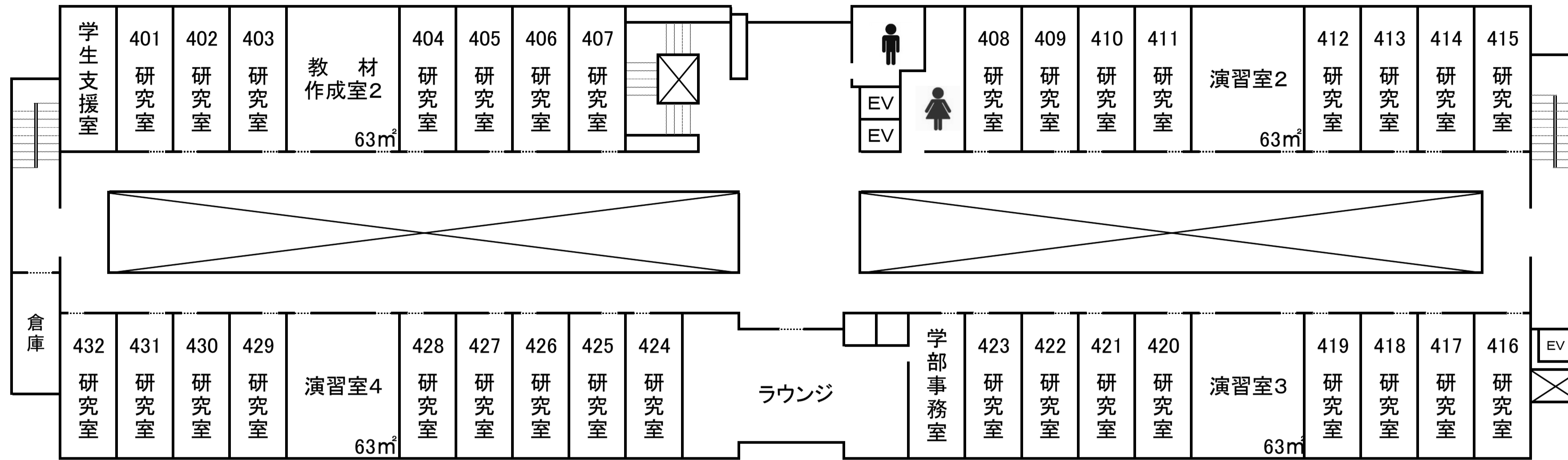

教 育 研 究 棟 3 階

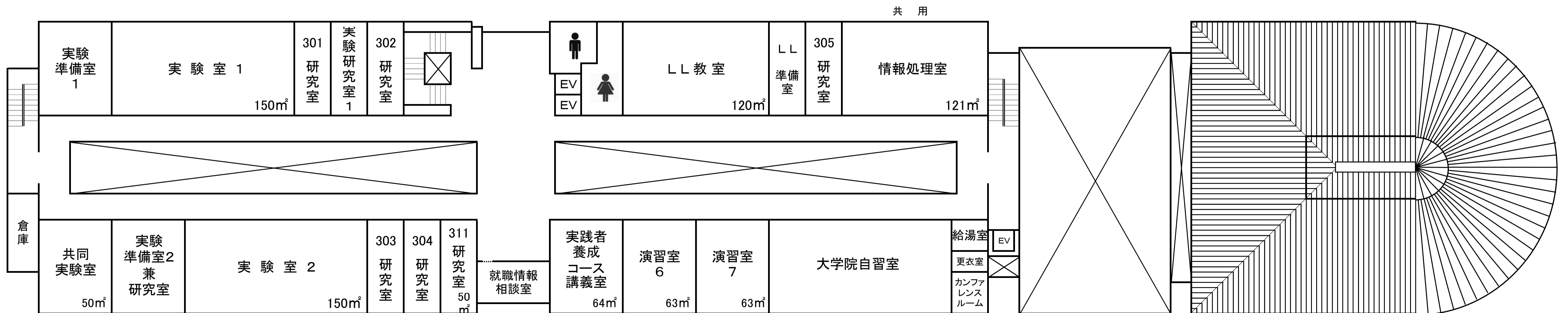

# 本館2階

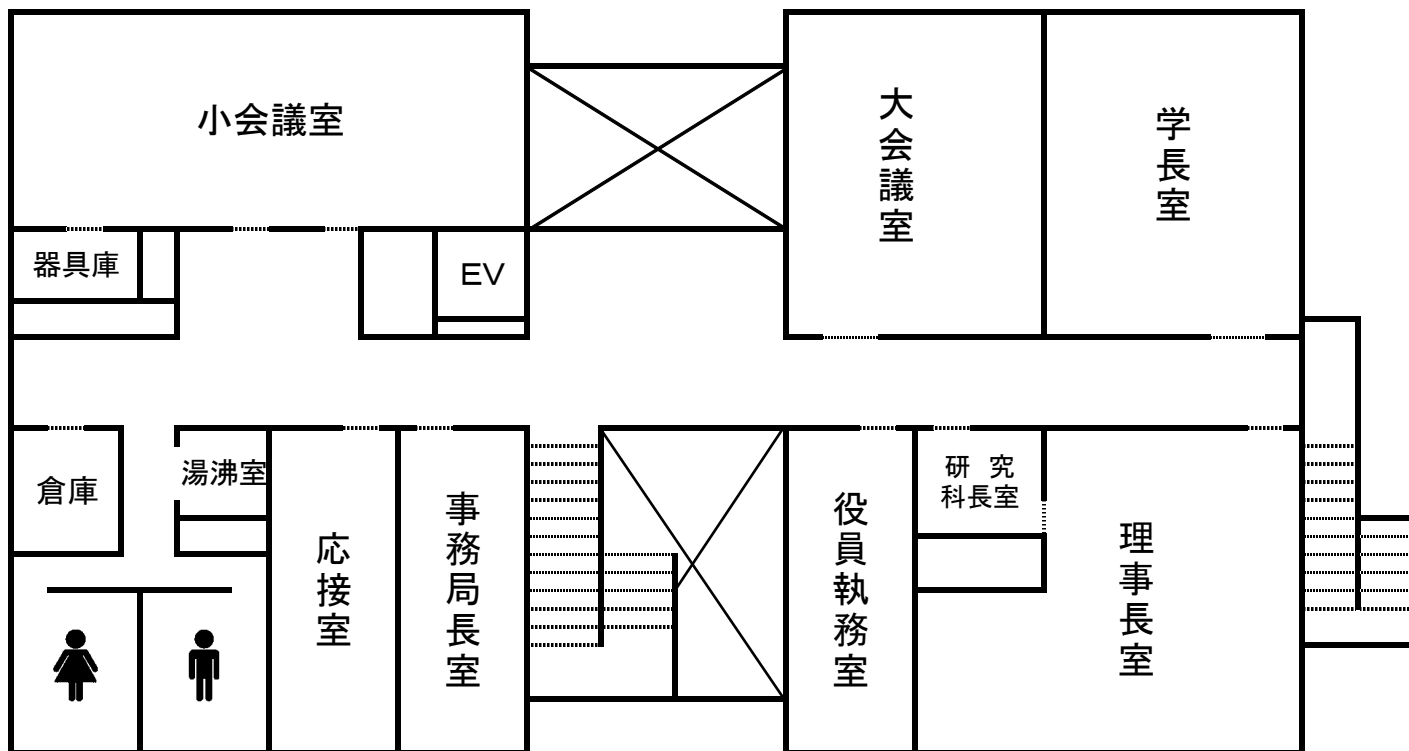

# 本館1階

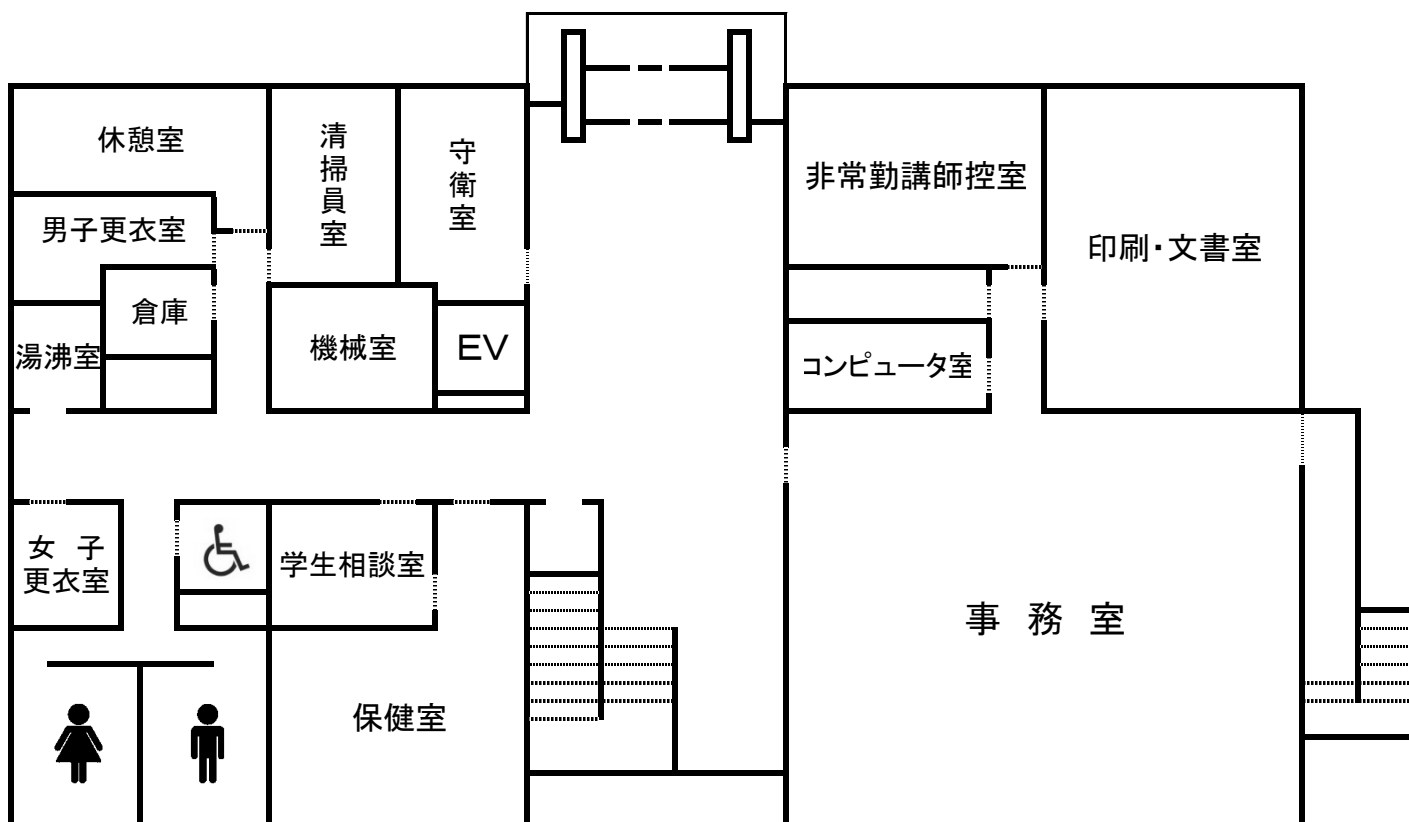

# 高木講堂 2階

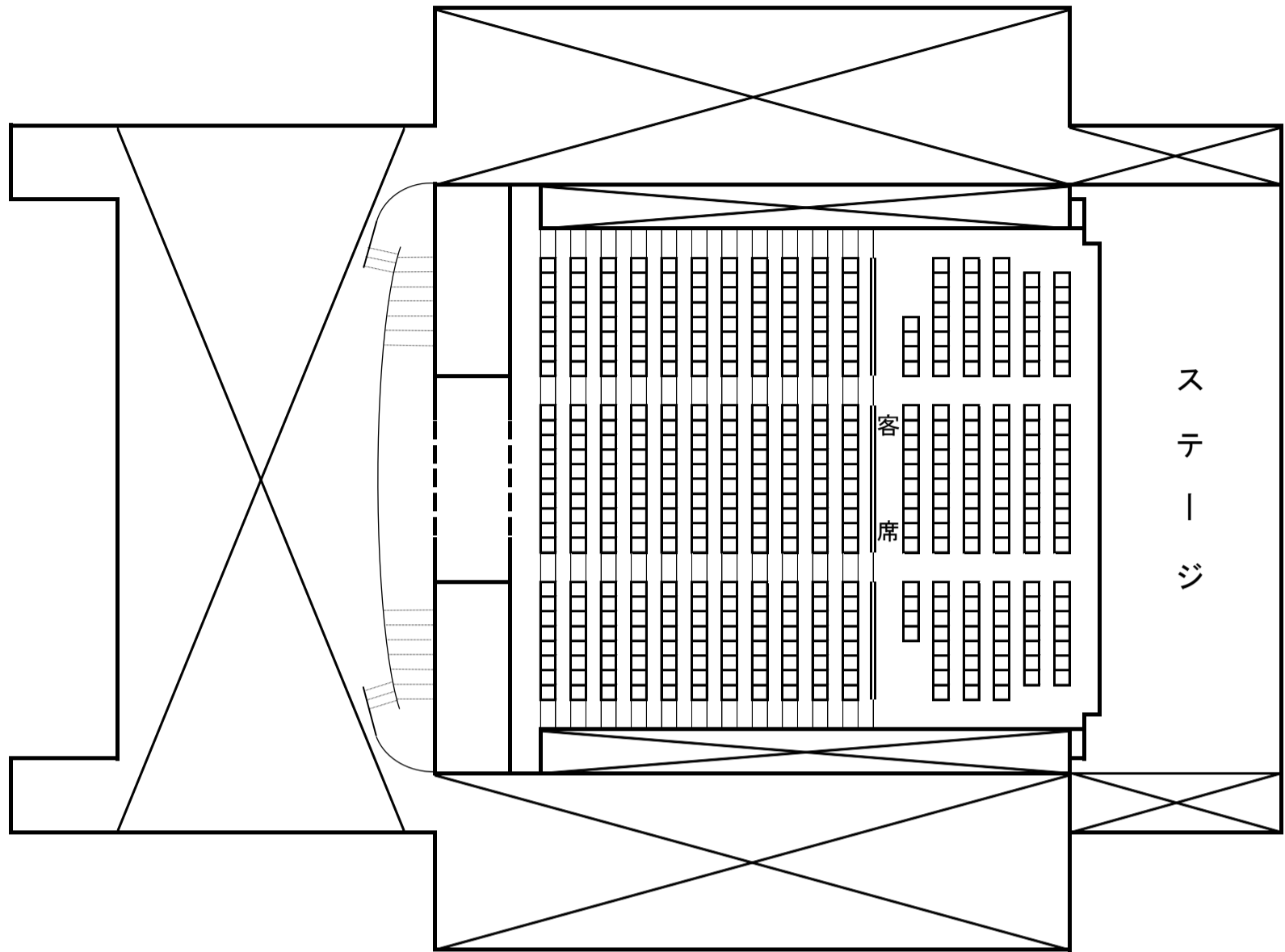

# 高木講堂 1階

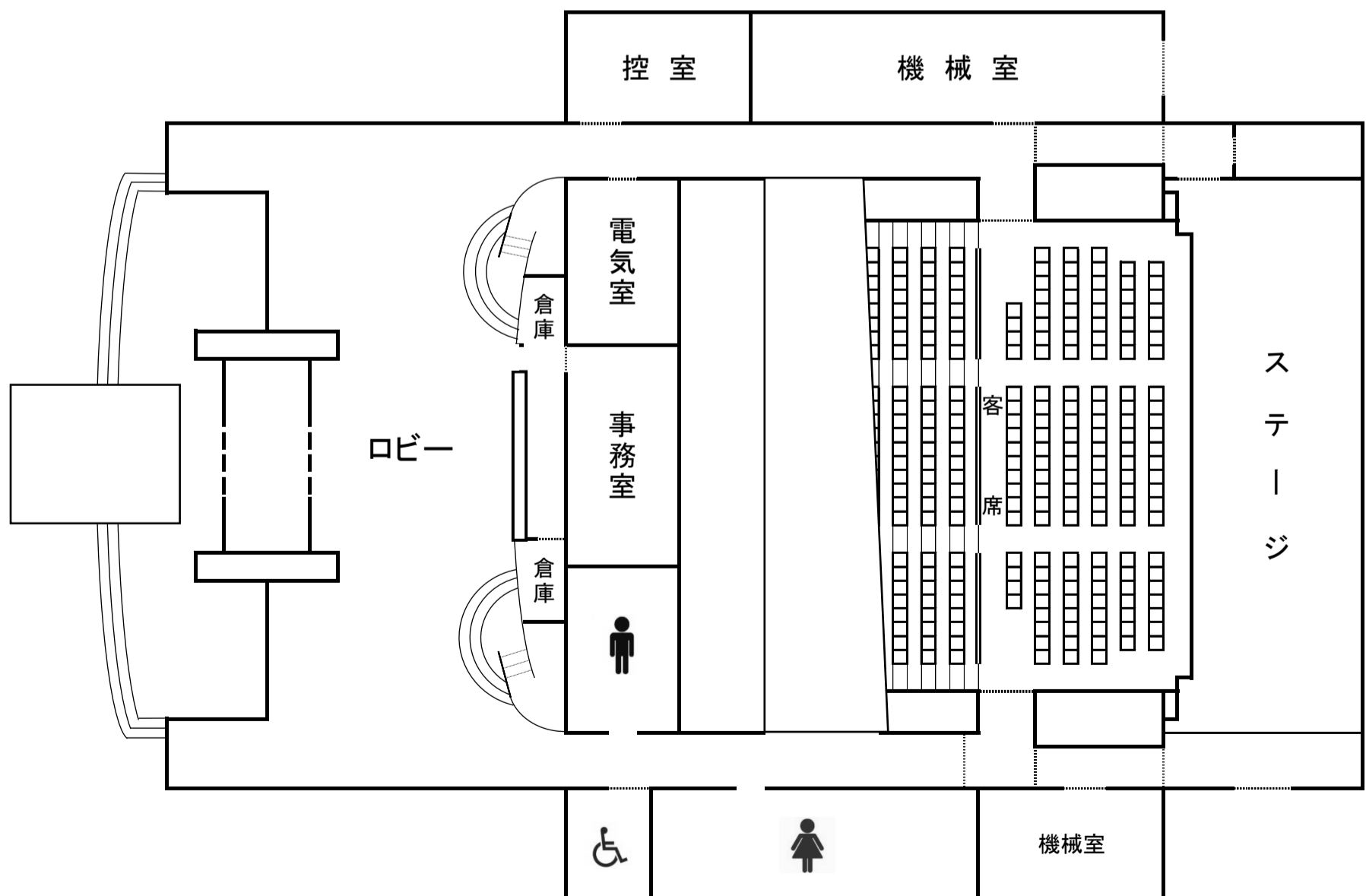

# 学生会館2階

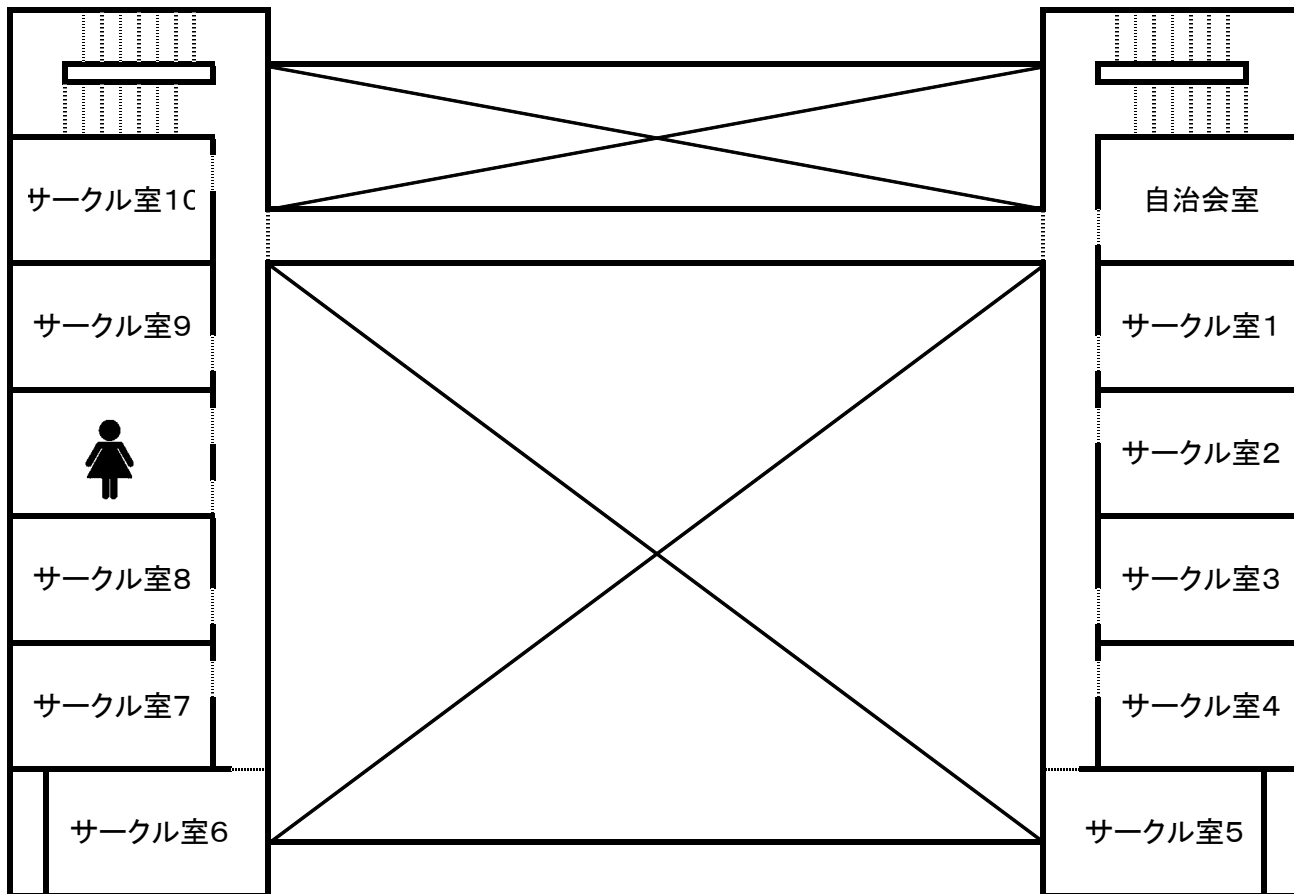

# 学生会館1階

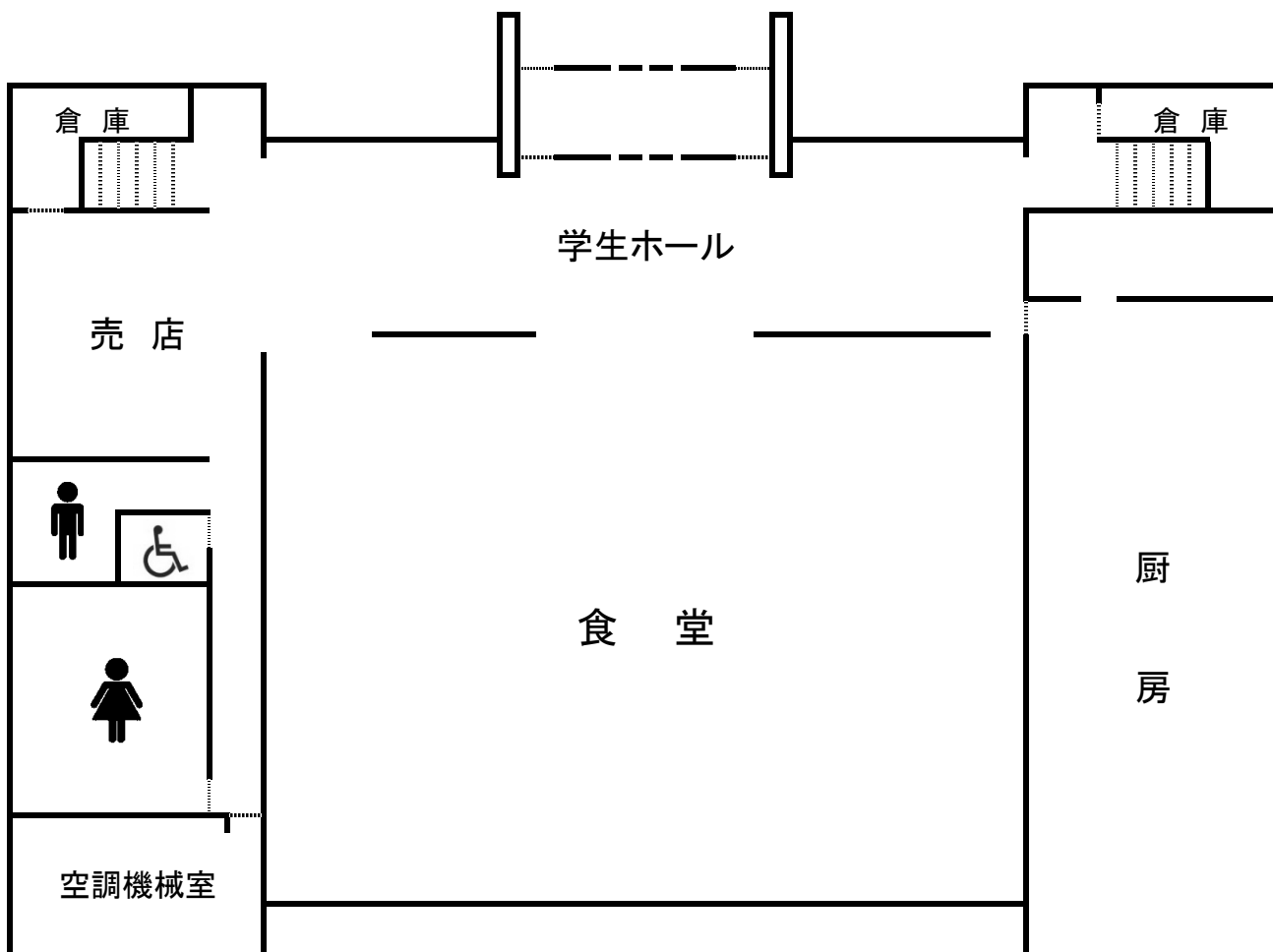

# 体育館2階

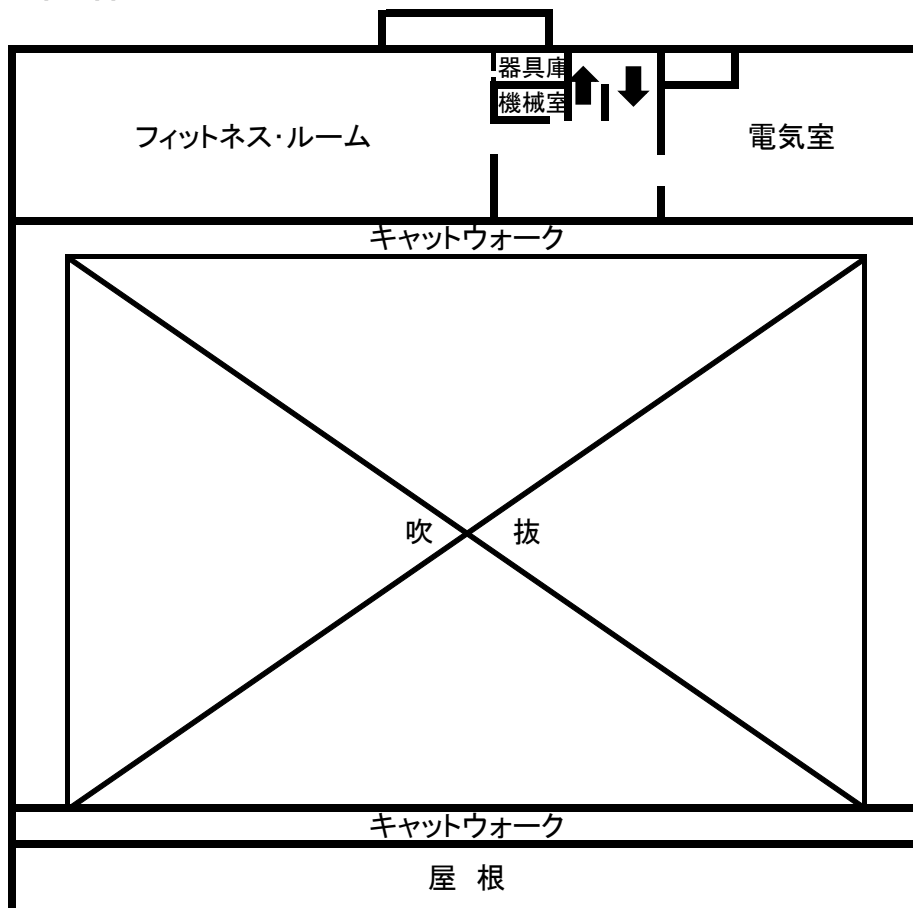

# 体育館1階

